

INSTALLATION GUIDE

Inductive Sensors ISIP

For further information please see the data sheet at www.waycon.biz/products/inductive-sensors-lvdt/

RECOMMENDED MOUNTING

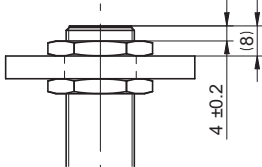

Tightening torque: 55 Nm

Failure to comply with this recommendation will result in an undesired deviation from published output characteristics.

Mounting set ISMZ-M18

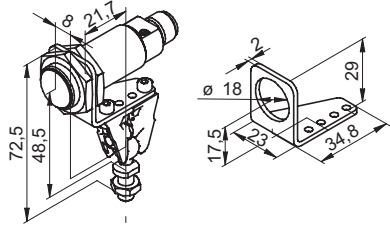

ELECTRICAL CONNECTION

Connector output M12, male, 4 pins

Pin	Signal
1	+V
2	Signal
3	GND
4	Signal

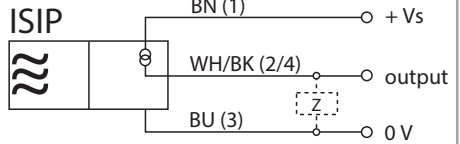
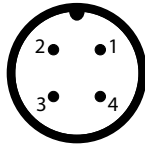

ACCESSORY CABLE

Cable with mating connector M12 (female), 4 poles

K4PXM-S-M12	X m, straight connector, shielded
K4PXM-SW-M12	X m, angular connector, shielded

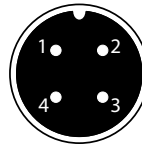

Pin	Cable colour
1	BN
2	WH
3	BU
4	BK

MAINTENANCE

Inductive sensors do not require any special maintenance or cleaning.



GENERAL SAFETY INSTRUCTIONS

Intended use

This product is a precision device and is used for object detection and the preparation and/or provision of measuring values as electrical quantities for a subsequent system. Unless this product is specially labelled, it must not be used for operation in hazardous environments.

Installation

- For mounting, use only the mechanical mountings and mechanical mounting accessories intended for this product.
- Always comply with admissible cable bending radii.
- Prior to electrical connection of the product, the system must be disconnected from the power supply.
- In areas where shielded cables are mandatory, they must be used as protection against electromagnetic interferences.
- If a connector is added by the customer to a shielded cable, an EMC version of the connectors should be used, and the shield must be connected to the connector housing across a large area.

DECLARATION OF EU-CONFORMITY

WayCon Positionsmesstechnik GmbH
Mehlbeerenstraße 4
82024 Taufkirchen / Germany

This is to certify that the products

Classification inductive sensors

Product series ISIP

fulfil the current request of the following EU-directives

EMC-directive 2014/30/EU

2011/65/EU

applied harmonized standards:

EN 60947-5-2:2007+A1:2012, Sec. 8.6, EN 60947-5-7:2003, Sec. 8.6,

EN 55011:2009+A1:2010, EN 55022:2010 (Class B), EN 50581:2012

This declaration of conformity loses its validity if the product is misused or modified without proper authorisation.

Taufkirchen, 05.07.2019

Andreas Träger
CEO