

# LINEAR POTENTIOMETER



## Series LZW2

### Key-Features:

- Housing diameter 19 mm
- Flexible mounting with brackets, rod end bearings or flange
- Available measurement ranges from 25 to 300 mm
- Linearity up to  $\pm 0.05\%$
- Displacement speed  $\leq 10$  m/s
- Protection class IP60
- Working temperature  $-30\dots+100$  °C
- Life cycle  $>25 \times 10^6$  m or  $>100 \times 10^6$  operations, whichever is less
- Simple apparatus according to the EN 60079-11

### Content:

Technical Data	....2
Technical Drawing	....2
Electrical Connection	....3
Order Code	....4
Accessories	....4



## TECHNICAL DRAWING

### LZW2-A

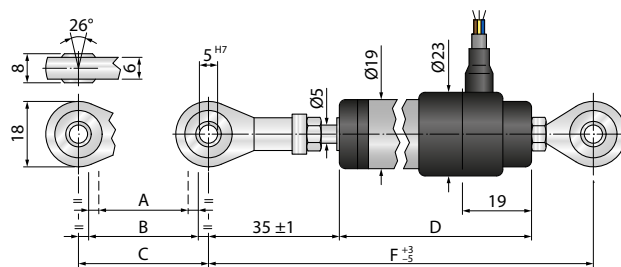

<b>Measurement range / useful electrical stroke +1/-0</b>	<b>A</b>	25	50	75	100	125	150	175	200	250	300
<b>Theoretical electrical stroke ±1</b>	<b>B</b>	26	51	76	101	126	151	176	201	251	301
<b>Mechanical stroke</b>	<b>C</b>	30	55	80	105	130	155	180	205	255	305
<b>Housing length LZW2-A</b>	<b>D</b>	110	135	160	185	210	235	260	285	335	385
<b>Minimum distance between rod end bearings</b>	<b>F</b>	163	188	213	238	263	288	313	338	388	438

## ELECTRICAL CONNECTION

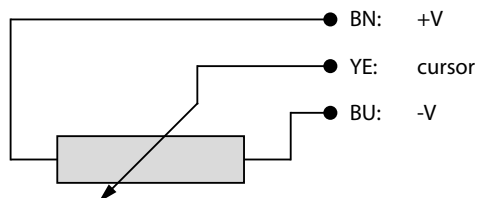

### Installation notes:

- Do **NOT** use the sensor as a variable resistor!
- While calibrating the sensor set the stroke so that the output signal does not drop below 1 % or exceed 99 % of the supply voltage.

## ACCESSORIES

### Signal conditioner PMX-24

- Converts potentiometer signals into analog output signals: 4...20 mA, 0...10 V, 0...5 V, ±10 V, ±5 V
- Input: potentiometer 1...20 kΩ
- Configurable output
- DIN-rail-mounting with face-side connector
- For more information please refer to the [PMX-24 data sheet](#).



## ORDER CODE

LZW2 - [ ] - [ ] - [ ]

**Version**

Installation with brackets  
 Installation with rod end bearings  
 Installation with flange

S  
 A  
 F

-  
 10M

**Cable length**

Standard 1 m  
 Optional 10 m

**Measurement range [mm]**

25 / 50 / 75 / 100 / 125 /  
 150 / 175 / 200 / 250 / 300

## ACCESSORIES

**Mounting accessories**

STA075 <sup>1)</sup> bracket for LZW2-S  
 SND004 rod end bearing with M5 external thread, housing side  
 SND005 rod end bearing with M5 internal thread, rod side

**Digital displays for sensors with analog output, 2 channel**

WAY-AX-S touch screen, supply: 18...30 VDC  
 WAY-AX-AC touch screen, supply: 115...230 VAC

For more information and options please refer to the [WAY-AX data sheet](#).

<sup>1)</sup> LZW2-S: 2 pcs. included in delivery

**Signal conditioner**

PMX-24 Output signals: 4...20 mA, 0...10 V, 0...5 V, ±10 V, ±5 V

For more information and options please refer to the [PMX-24 data sheet](#).

Subject to change without prior notice.

**WayCon Positionsmesstechnik GmbH**

Email: [info@waycon.de](mailto:info@waycon.de)

Internet: [www.waycon.biz](http://www.waycon.biz)

**WayCon**

Positionsmesstechnik

**Headquarters Munich**

Siemensstr. 5

85521 Ottobrunn

Tel. +49 (0)89 67 97 13-0

**Office Cologne**

Auf der Pehle 1

50321 Brühl

Tel. +49 (0)89 67 97 13-100